

# CLAMPBO®



## CHAIN BLOCK

MODEL NOS: CCH500B, CCH1000B, CCH2000B & CCH3000B

Part Nos: 7630452, 7630462, 7630472 & 7630482

## OPERATING & MAINTENANCE INSTRUCTIONS



---

## INTRODUCTION

---

Thank you for purchasing this CLARKE chain block.

Before attempting to use the product, it is essential that you read this manual thoroughly and carefully follow all instructions. In doing so you will ensure the safety of yourself and that of others around you, and you can also look forward to the product giving you long and satisfactory service.

---

## INTENDED USE

---

The chain block is a portable lifting device easily operated by hand. It is suitable for use in factories, mines, farms, construction sites, docks and warehouses for the installation of equipment or for loading and unloading goods. It is specially advantageous for lifting work in open spaces where no power supply is available.

The chain block can be attached to a trolley of any type as a travelling chain block. It is suitable for use with a monorail overhead conveying system, hand travelling crane and jib crane.

---

## GUARANTEE

---

This CLARKE product is guaranteed against faulty manufacture for a period of 12 months from the date of purchase. Please keep your receipt as proof of purchase.

This guarantee is invalid if the product is found to have been abused or tampered with in any way, or not used for its intended purpose.

Faulty goods should be returned to their place of purchase, no product can be returned to us without prior permission.

This guarantee does not effect your statutory rights.

---

## SAFETY PRECAUTIONS

---

### ALWAYS:

- Inspect the general condition of the chain block and chains for signs of damage or wear before placing into storage.
- Check that the load hook will reach it's lowest point without running the chain fully out.
- Ensure that the suspension point is strong enough to take the weight of the chain block and it's load.
- Check the travel path is clear and that you have a clear view so as to avoid any obstructions.
- Wear industrial gloves when operating the chain block.
- Wear a hard hat, steel toe capped boots and safety goggles when operating the chain block.

### NEVER:

- Lift a load exceeding the rated capacity stated on the chain block.
- Use the chain block when the chain is kinked.
- Stand beneath a raised load.
- Use the chain block if it requires more than ordinary effort to operate it.
- Throw, drop or drag the chain block.
- Use undue effort to force the block to operate.
- Allow oil or grease to come into contact with the brake.
- Lift loads at an angle or use for towing. Only lift loads vertically.
- Never replace the load chain with a non-approved spare chain.
- Never operate with other people close by.

---

## BEFORE LIFTING

---

1. Careful inspection should be made to the parts, such as hooks, load chain, braking device, etc. and the lubrication of the block. The chain block can only be put into use when it is confirmed to be in good condition.
2. Ensure that the weight of the load to be lifted is within the safe rated load of the chain block.
  - Never overload the block at any time.
3. Attach the chain block securely to the suspension point, ensuring that the hook and chain block hang vertically without twisting.
  - The suspension point must be able to support the gross weight of the load and the chain block.
4. Attach the load hook directly to the load or sling, ensuring it is directly above the centre of gravity of the load.

---

## OPERATION

---

1. Ensure that there is no obstruction preventing a clean lift.
2. Gently raise or lower the load by pulling the hand chain through the block in the desired direction - clockwise to lift and anti-clockwise to lower.
  - While lifting or lowering a load, the hand chain should be pulled steadily without jerking so as to prevent it from tangling.
  - Always take care to pull the hand chain in line with the plane of the handwheel to ensure the chain passes smoothly through the mechanism.
  - Lift the load sufficient to take up the strain and check stability before commencing full lift.
  - Do not allow anyone to walk or work under any load being lifted.
  - Always look for any defects occurring during operation and stop using the chain block if any are seen.
  - When lowering a load, be aware that when the hand chain is released, the load will not stop immediately, but may continue for a few more millimeters as the brake takes effect.

**NOTE:** The brake may get hot with continued use.

3. Stop operation immediately if the chain jams and cannot be pulled any further. Never try to force it.
4. If this happens, inspect the equipment for the following:

- a. Check if there is anything entangled with the load.
- b. Check whether there is any jamming parts of the block.
- c. Check whether the weight being lifted exceeds the rated capacity of the block.

---

## MAINTENANCE

---

After operation, clean the chain block and lubricate the chain if required. Store it in a dry place to protect it from rust and corrosion.

### EVERY SIX MONTHS

- Fully unwind the lifting chain and check it's general condition for corrosion, wear, or signs of stretching or fracture.
- Check the security and condition of the suspension point.
- Check the condition of the hooks and the tightness of all bolts and screws.

**NOTE:** When in constant use, the chain block should be inspected more frequently, (at least monthly).

If in doubt about the use or maintenance of this equipment, or if overhaul requiring the dismantling of the unit is required, consult your local authorised CLARKE dealer.

---

## SPECIFICATIONS

---

|                      | CCH500B | CCH1000B | CCH2000B | CCH3000B |
|----------------------|---------|----------|----------|----------|
| Capacity (tonnes)    | 0.5     | 1        | 2        | 3        |
| Maximum Lift (M)     | 3       | 3        | 3        | 3        |
| Load Chain Dia. (mm) | 5.9     | 5.9      | 5.9      | 5.9      |
| Gross Weight (kg)    | 9.25    | 9.4      | 12.75    | 21.5     |
| Part Nos.            | 7630452 | 7630462  | 7630472  | 7630482  |

# DECLARATION OF CONFORMITY



**Clarke**<sup>®</sup>  
**INTERNATIONAL**

Hemnal Street, Epping, Essex CM16 4LG

## DECLARATION OF CONFORMITY

This is an important document and should be retained.

We hereby declare that this product(s) complies with the following directive(s):

2006/42/EC Machinery Directive.

The following standards have been applied to the product(s):

EN 13157/A1:2009

The technical documentation required to demonstrate that the product(s) meet(s) the requirement(s) of the aforementioned directive(s) has been compiled and is available for inspection by the relevant enforcement authorities.

The CE mark was first applied in: 2009

|                               |                            |
|-------------------------------|----------------------------|
| <b>Product Description:</b>   | Chain Hoists               |
| <b>Model number(s):</b>       | CCH500B,1000B,2000B, 3000B |
| <b>Serial / batch Number:</b> | N/A                        |
| <b>Date of Issue:</b>         | 16/12/2011                 |

Signed:

J.A. Clarke  
Director

# COMPONENT PARTS

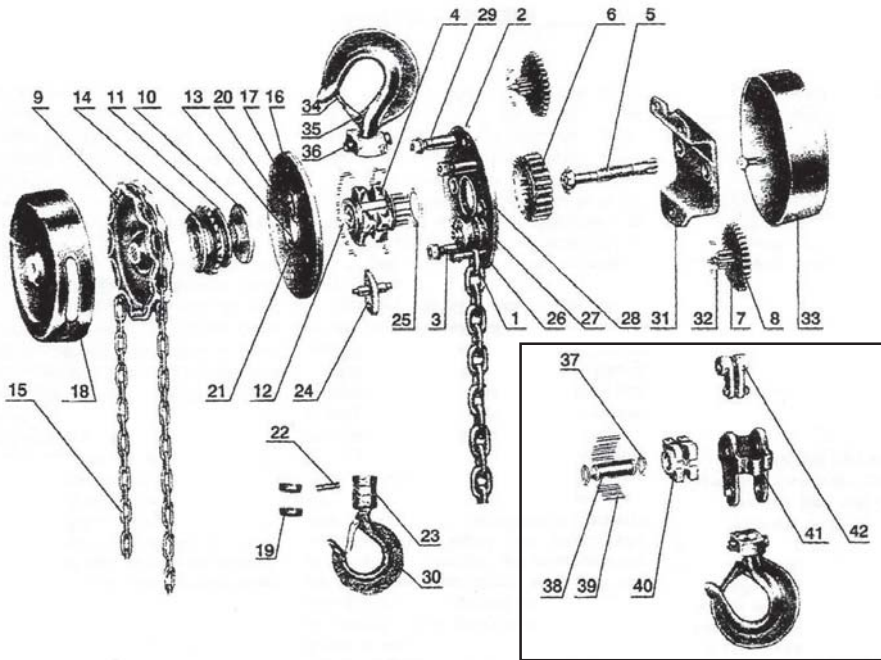

|                        |                    |                     |                   |                     |
|------------------------|--------------------|---------------------|-------------------|---------------------|
| 1.Load Chain           | 10.Brake Seat      | 19.Ring             | 28.Bearing Race   | CCH2000B only       |
| 2.Righthand Side Plate | 11.Friction Plate  | 20.Pawl Pin         | 29.Stay (B)       | 37.Snap Ring        |
| 3.Stay (A)             | 12.Roller          | 21.L/H Side Plate   | 30.Hook           | 38.Shaft            |
| 4.Chain Sprocket       | 13.Bearing Race    | 22.Chain Pin        | 31.Bent Plate     | 39.Needle           |
| 5.Driving Shaft        | 14.Ratchet Disc    | 23.Lower Hook Block | 32.Roller         | 40.Idler Sheave     |
| 6.Splined Gear         | 15.Hand Chain      | 24.Stripper         | 33.Sheet Cover    | 41.Hook Hanger      |
| 7.Pinion Shaft         | 16.Pawl Spring     | 25.Snap Ring        | 34.Latch Clamp    | 42.Suspension Plate |
| 8.Disc Gear            | 17.Pawl            | 26.Pin              | 35.Headless Rivet |                     |
| 9.Hand Wheel           | 18.Handwheel Cover | 27.Guide Roller     | 36.Hook Holder    |                     |

# A SELECTION FROM THE VAST RANGE OF

# Clarke®

## QUALITY PRODUCTS

### AIR COMPRESSORS

From DIY to industrial, Plus air tools, spray guns and accessories.

### GENERATORS

Prime duty or emergency standby for business, home and leisure.

### POWER WASHERS

Hot and cold, electric and engine driven - we have what you need

### WELDERS

Mig, Arc, Tig and Spot. From DIY to auto/industrial.

### METALWORKING

Drills, grinders and saws for DIY and professional use.

### WOODWORKING

Saws, sanders, lathes, mortisers and dust extraction.

### HYDRAULICS

Cranes, body repair kits, transmission jacks for all types of workshop use.

### WATER PUMPS

Submersible, electric and engine driven for DIY, agriculture and industry.

### POWER TOOLS

Angle grinders, cordless drill sets, saws and sanders.

### STARTERS/CHARGERS

All sizes for car and commercial use.



**PARTS & SERVICE: 020 8988 7400**  
E-mail: [Parts@clarkeinternational.com](mailto:Parts@clarkeinternational.com) or [Service@clarkeinternational.com](mailto:Service@clarkeinternational.com)

**SALES: UK 01992 565333 or Export 00 44 (0)1992 565335**

**Clarke** INTERNATIONAL Hemnall Street, Epping, Essex CM16 4LG  
[www.clarkeinternational.com](http://www.clarkeinternational.com)